

# 土木工学研究棟

## Civil Engineering Research Building

- Top-level research environment
  - Multi-objective, multi-application design of laboratories
  - High efficiencies by shared use
  - Enhancement of research outreaches
- 



# Environment to support new research organization

- Change a small research group to bigger one
- Like Domestic Industry to Great Industry
- Laboratory→Division→Future organization
- Shared use of apparatuses owned by each laboratory→Increase operation rate
- Improvement of working space (air-conditioning system, OA floor, temperature-controlled laboratory, comfortable environment)
- Outreaches of civil engineering research

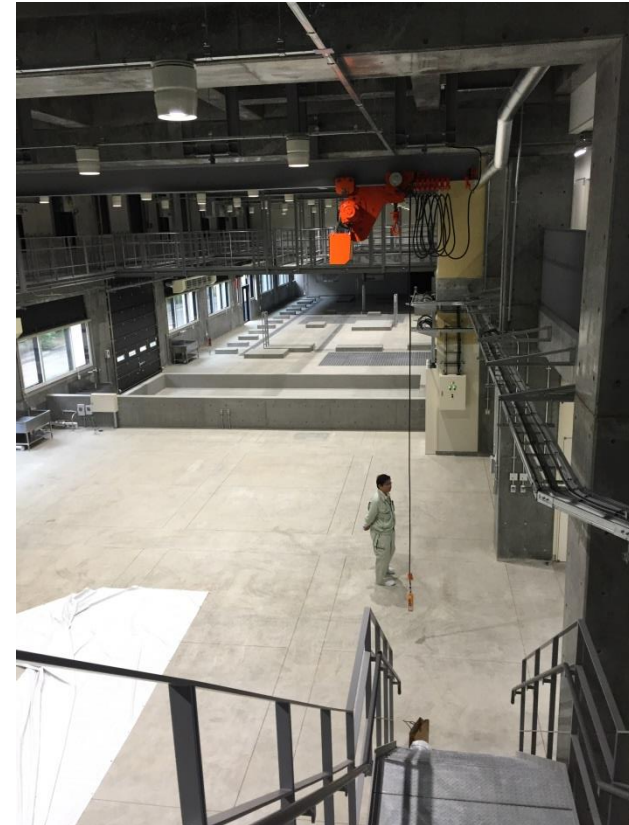

# Laboratory environment

- Non-smoking
- All rooms have specific functions.
- **Student room**: space where students just study (No alcohol drinking, no party and event, no loud talking and meeting, no activity to bother other students.)
- Prohibit to bring anything irrelevant to research in the student room, such as refrigerator, microwave, sofa.
- **Refresh Lounge**: for break, talk, meeting, eating, drinking, party
- **Isami Hiroi Memorial Laboratory**: multi-objective room (temporal working space for visitors, undergraduate students and past students, activities of job search, seminar, meeting, event, party)
- **Seminar room** (seminar, meeting event)

# Rule to use Student Room (304,305,306,404,405)

- No smoking, No alcohol drinking
- Take a special care to maintain calm environment (not talk loudly) as this is a shared place with multiple laboratories.
- Prohibit any party or event.
- Wifi access only for PC (Ask your supervisor if your PC does not have wireless communication function)
- Permit to use online connection only for devices requiring static IP, such as a network printer.
- Encourage to use wireless network printer (Ask your supervisor)
- Prohibit to use any extension cables (electricity, LAN)
- Prohibit to move desks and shelves without permission
- Carefully turn off light and air-conditioning (electricity charge affect research budgets!)

# Request for use of Student Room

- Build a room association across laboratories
- Make rules for cleaning, trash management
- Students for the same supervisor should use neighboring desks
- Do not keep a desk on a first-come first-served basis
- Do not cover windows facing a hallway and cloudy window on the wall between the rooms (304-305, 404-405). They are lighting windows.



# Where to work



- 304 Shimizu(2), Ishikawa(8), Watanabe(4), Uchida(12), Nishimura(7), Tanaka(7)
- 305 Ueda(8), Yokota(13), Furuuchi(7), Sato Y(6)
- 306 Izumi(3), Watabe(5), Kimura(3), Isobe(6), Yokohama(3), Lima(2), Yamada(3), Fukuda(1)



# Where to work

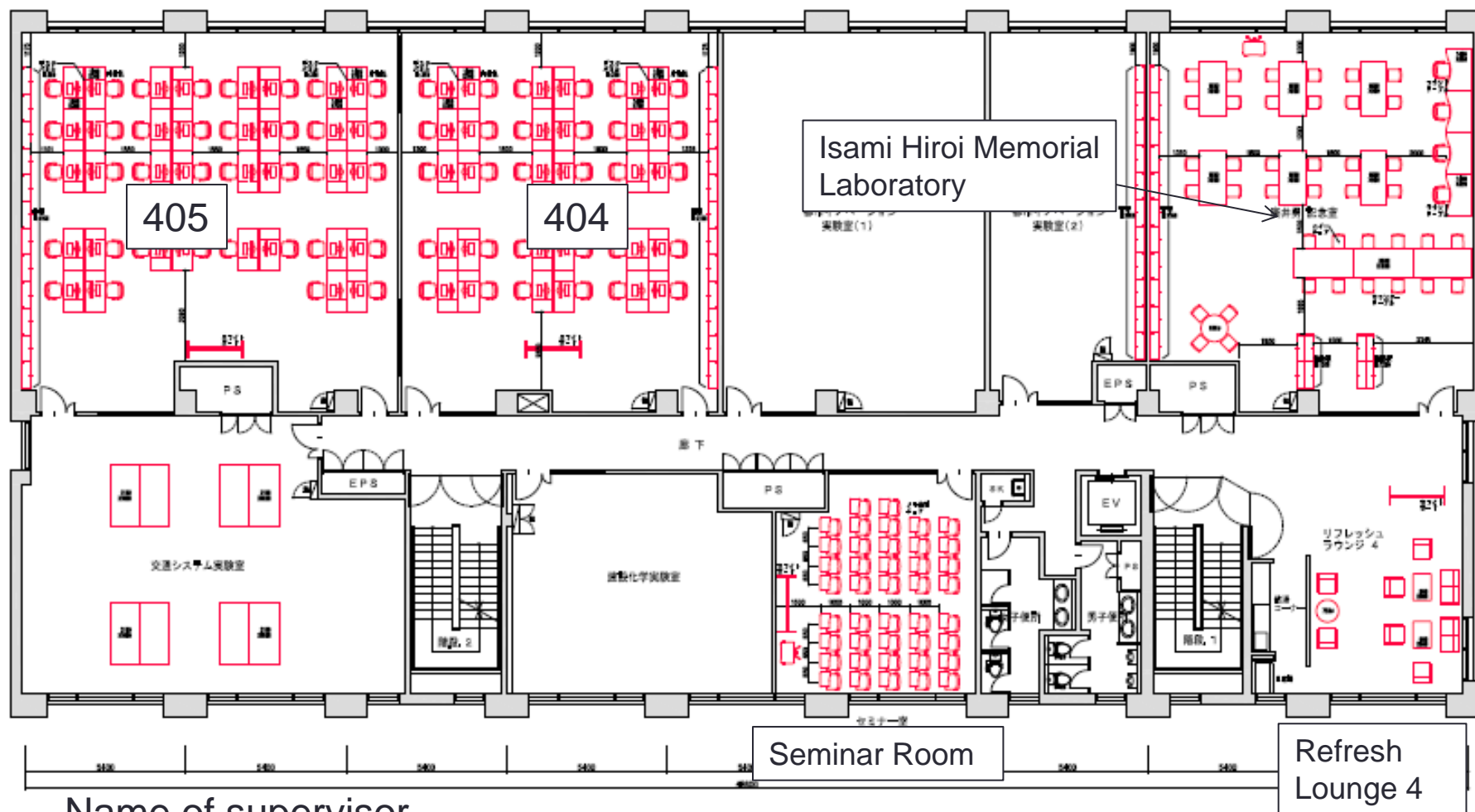

Name of supervisor

404 Kanie(8), Hagiwara(11), Takano(6), Zheng(5)

405 Sugiyama(5), Kishi(11), Sato T(5), Shimura(1), Saruwatari(2),  
Matsumoto(3), Henry(9), Regina(3)

# Seminar Room

- Audio and visual system equipped
- Book the room on a room booking system
- HINES WLAN

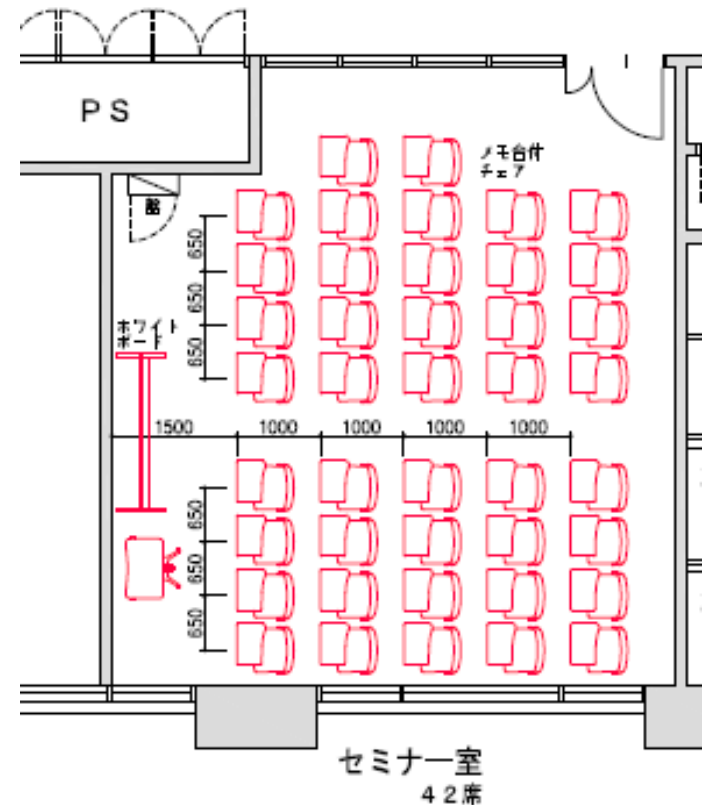



# Isami Hiroi Memorial Laboratory

- Work tables (6), desks(4), counter-table (1), table(1)
- Desks for visiting researches (need reservation)
- work tables, counter-table, table are designed for temporal use by visitors and undergraduate students
- Articles associated with job search are stored in magazine racks
- temporal use by past students for student' job search and meeting

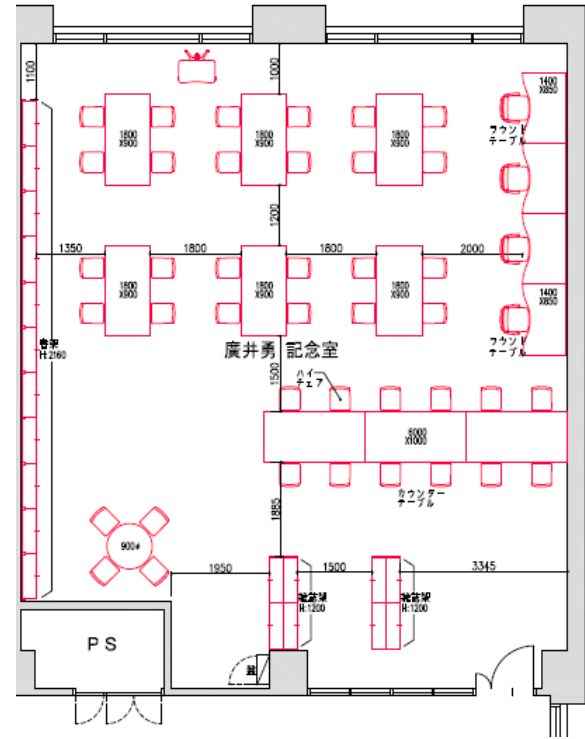

# Refresh Lounge

- drinking, eating, break, meeting
- Place refrigerator, microwave
- Use air-conditioning for heating in winter
- Allow to use electric heaters if more warming is needed

Coin machine space

Air-conditioning controller

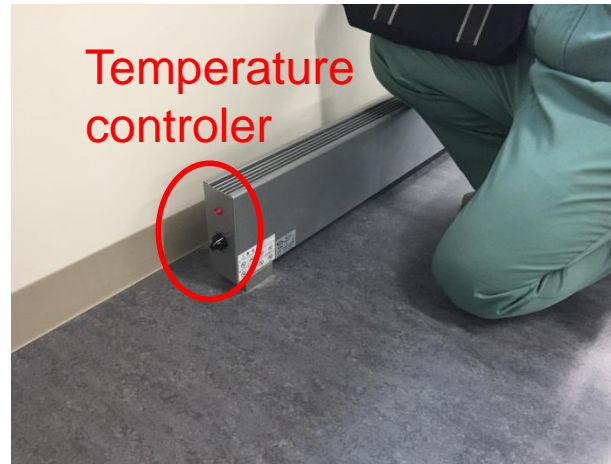
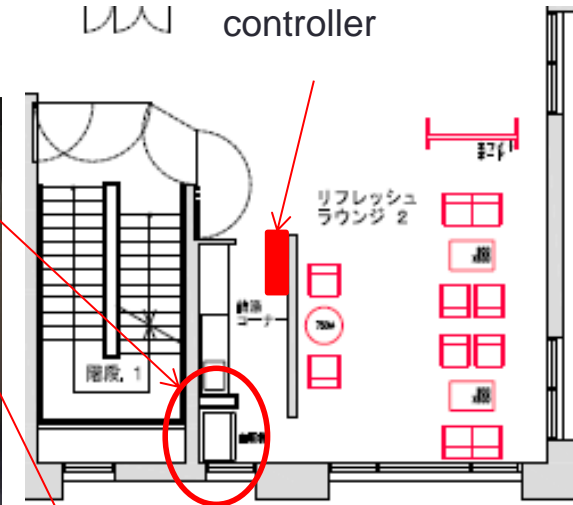

# Network

Student rooms (304,305,306,404,405)

- Hines WLAN (wifi) access only for PC (Login with student ID and Password)  
→ Manage ID and Pass by yourself
- Set up DHCP connection → Ask your supervisor to register your DHCP connection.
- If your PC uses static IP connection, change to DHCP.
- If your PC has no wireless network device, you cannot use internet (Ask your supervisor)
- Permit to use online connection (with Lan cable) only for devices requiring static IP, such as a network printer.
- Place devices with LAN cables near the LAN port (not to use extension cables)
- Ask a manager of network port of your room to register static IP

In Isami Hiroi Memorial Laboratory, eduroam is available (visitor can access internet)

# Manager of network port

1 <sup>st</sup> floor E P S			
H U B Number		X 1 4 D 1	
Port	Cable ID	room	manager
01	H1-1	NA	
02	H1-2	1F Structural testing Lab	Sato Y
03	H1-3	1F Lab of cold region env	Zhang
04	H1-4	1F Geotechnical model testing Lab	Yokohama
05	H1-5	1F Lab of geophysical fluid dynamics	Saruwatari
06	H1-6	1F Lab of geophysical fluid dynamics	Saruwatari
07	H1-7	1F Lab of geophysical fluid dynamics	Saruwatari
08	H2-1	2F Sever room	Watanabe
09	H2-2	2F Sever room	Saruwatari
10	H2-3	2F Sever room	Yamada
11	H2-4	2F Construction material lab	Sugiyama
12	H2-5	2F Bridge design Lab	Matsumoto
13	H2-6	2F Soil testing Lab (3)	Yokohama
14	H2-7	2F Low-temperature Lab	Yokohama
15	H2-8	2F Lab of tsunami floods	Watanabe
16	H2-9	2F Lab of global water cycle	Yamada
17	H2-10	2F Lab of planetary environment	Izumi

3 <sup>rd</sup> floor E P S			
H U B Number		X 1 4 D 3	
Port	Cable ID	room	manager
01	H3-1	3F power room	
02	H3-2	3F Technical staff room	Sato Y
03	H3-3	3F 306 LAN	Kimura
04	H3-4	3F 306 WLAN	Watanabe
05	H3-5	3F 305 LAN	Furuuchi
06	H3-6	3F 305 WLAN	Watanabe
07	H3-7	3F 304 LAN	Tanaka
08	H3-8	3F 304 WLAN	Watanabe
09	H3-9	3F Soil testing Lab (1)	Yokohama
10	H3-10	3F Soil testing Lab (2)	Nishimura
11	H3-11	3F temperature-controlled room	Nishimura

4 <sup>th</sup> floor E P S			
H U B Number		X 1 4 D 4	
Port	Cable ID	room	manager
01	H4-1	4F Lab for transportation & traffic systems	Kishi
02	H4-2	4F Seminar room	Watanabe
03	H4-3	4F 405 LAN	Kishi
04	H4-4	4F 405 WLAN	Watanabe
05	H4-5	4F 404 LAN	Zhang
06	H4-6	4F 404 WLAN	Watanabe
07	H4-7	4F Lab for urban innovation (1)	Kishi
08	H4-8	4F Lab for urban innovation (2)	Kishi
09	H4-9	4F Isami Hiroi Memorial Lab	Watanabe
10	H4-10	4F Construction chemistry Lab	Sugiyama

# Keys

- Card key lock at entrance  
Unlocked from 8:00 to 20:00
- Numeric keypad lock (from September)  
Confirm the door is locked when you leave
- Ask your supervisor for key plan of laboratories
- Do not buy copy of a key by yourself. Ask your supervisor if you need the copy.
- ※ There have been thieves in the University!  
Manage the key carefully.



Room #	Room	Ext
101	Lab of geophysical fluid dynamics	6200
102	Structural testing Lab	6181
103	Geotechnical model testing Lab	6195
201	Lab of planetary environment	6190
202	Lab of global water cycle	7165
203	Lab of tsunami floods	6186
204	Soil testing Lab (3)	6779
206	Bridge design Lab	6173
207	Construction material lab	7553
302	土質実験室(2)	6196
303	土質実験室(1)	7574

## Phone number

Room #	Room	Ext
304	304 Student Room	6213
305	305 Student Room	6182
306	306 Student Room	6229
307	Technical staff room	6207
402	Lab for urban innovation (2)	6212
404	404 Student Room	6177
405	405 Student Room	6208
407	Construction chemistry Lab	7897
408	Lab for transportation & traffic systems	6217



# Air-conditioning

- Easy operation (but indication in Japanese.. Ask Japanese students for operation)
- Automatically turn off the air-conditioning for student rooms (304,305,306,404,405), Isami Hiroi Room, Seminar Room at 0:00 midnight. You can turn after 0:00 on if you want. Turn off again when you leave.
- All rooms except 1F use the air-conditioning for heating
- 24h-ventilation is obligated by law. But it's too noisy...temporal activation may be acceptable...

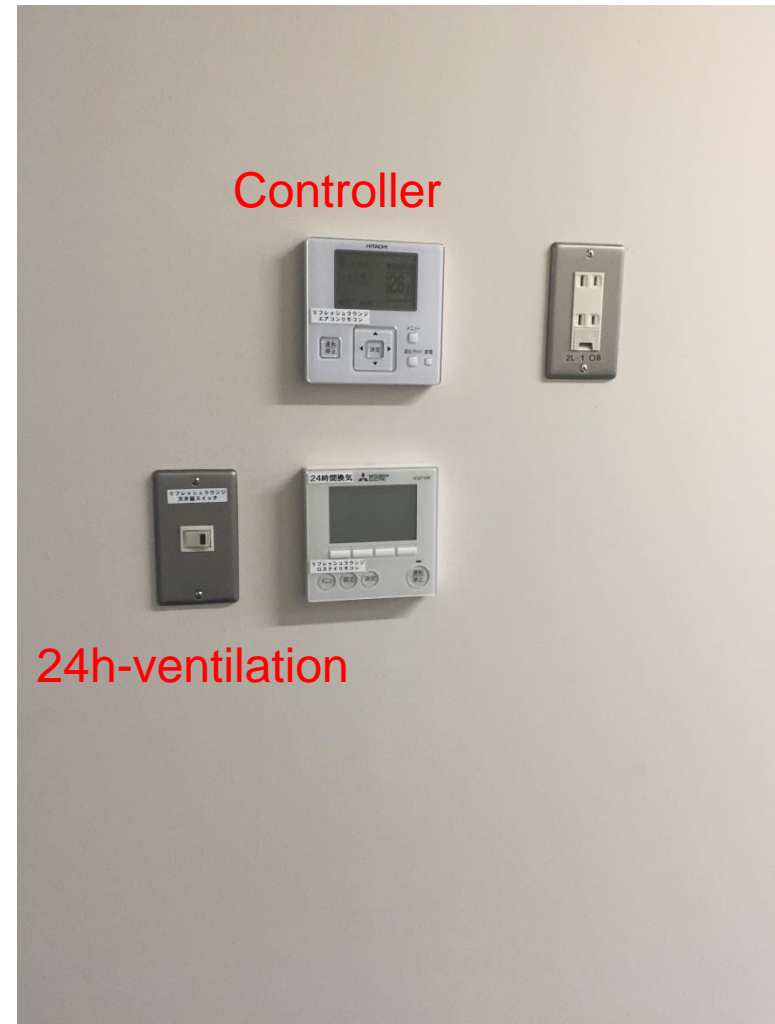

# Circuit breaker

- Circuit breaker box at the places of `EPS' on a plan drawing
- When blowing a breaker, turn on the breaker for the corresponding outlet number and ask your supervisor.
- If EPS is locked, ask your supervisor.

大元のブレーキには触らない  
→全ての電源が落ちます

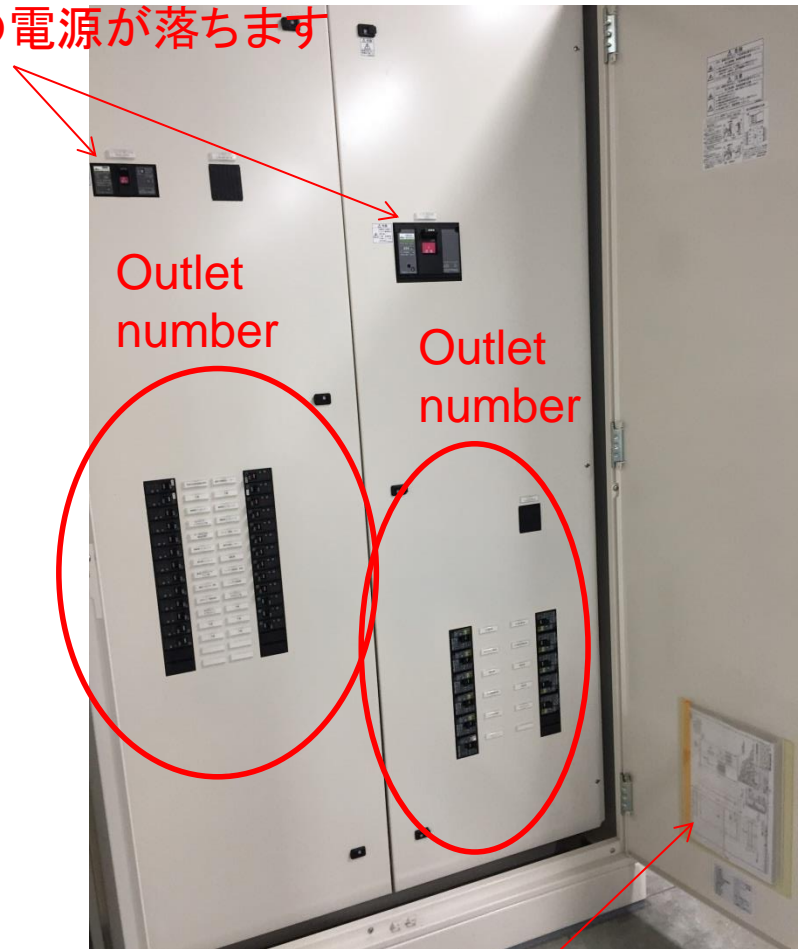

Diagram of electricity  
distribution

# Restroom

## 1F Multi-purpose restroom

emergency string→alert to security guards  
→Do not pull except emergency

## Lady's restroom

press an emergency button when emergency→Flushing lights on a hallway with siren

For cancel, take out the cover of the button and pull the button

## Emergency shower

it's only for emergency (e.g. poured chemical matters)  
Do not use it except emergency ! No hot water comes out.



emergency string



emergency button



Emergency light



Pull the button for cancel



Emergency shower

# 1F Radiation heaters

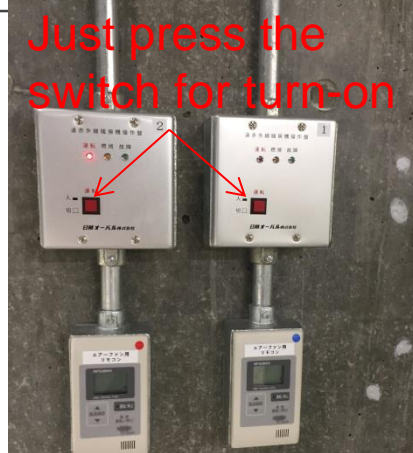
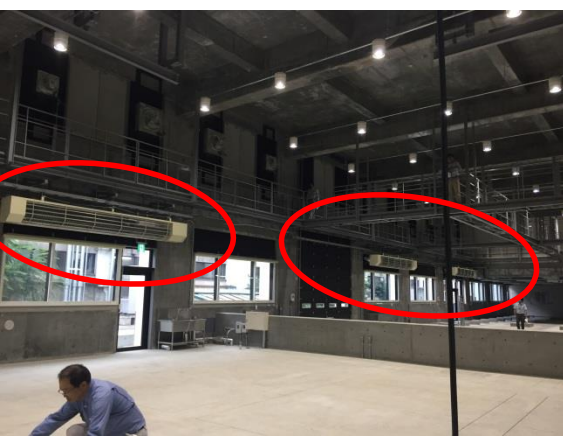
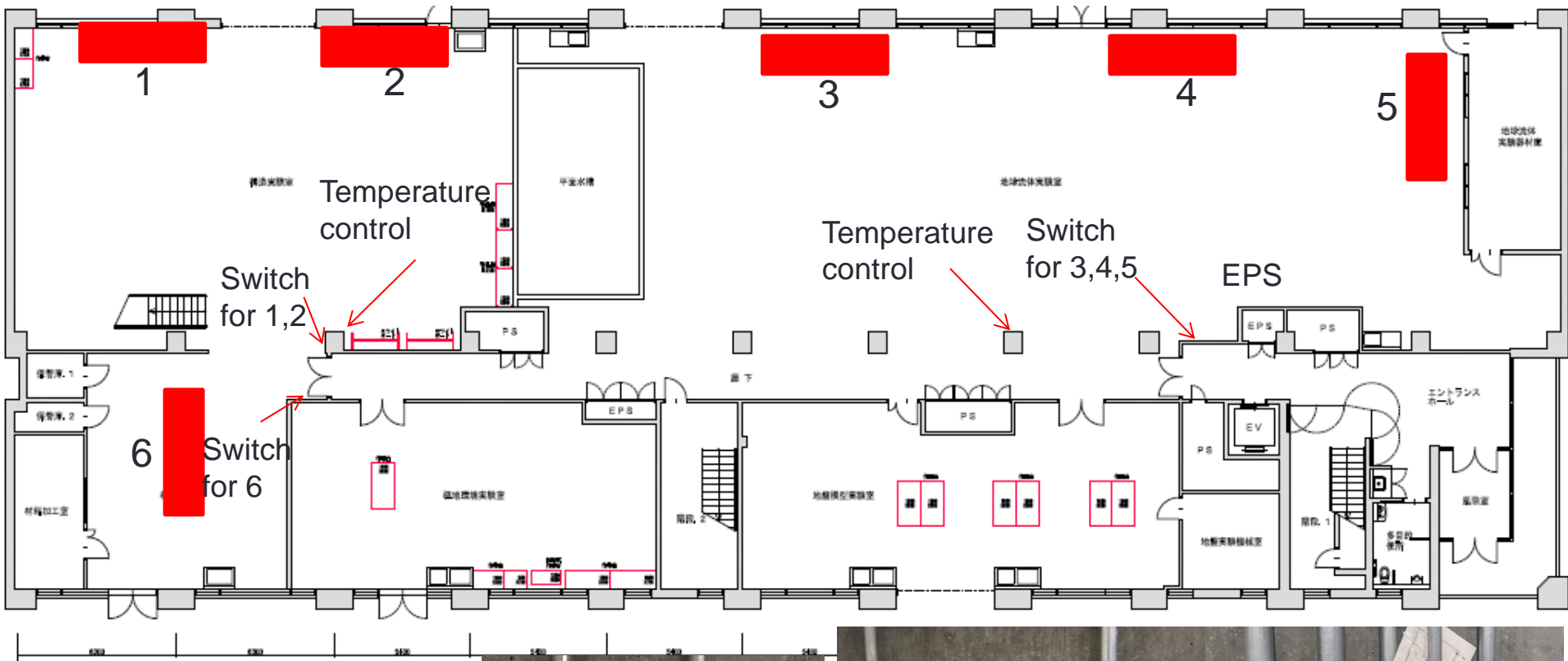

# Important reminder for 1F laboratories

- Lock all doors and shutters any time except when using them
- Security guard is not responsible for the doors and shutters on 1F. Manage lock-up by yourself.

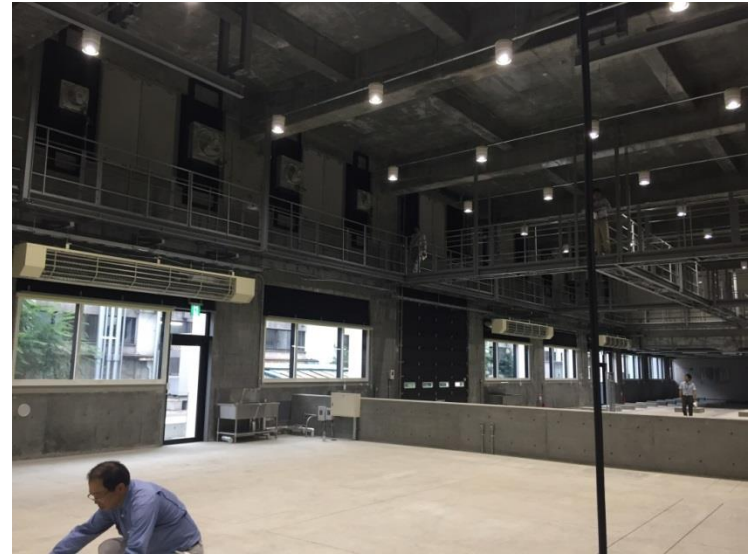

## 2F Catwalk

- It's for maintenance the building (the designed load for the structure is just weight of 5 people.) Do not use it except when you need to use.
- We will lock up for safty.



# Moving

- Capacity of book shelves is limited, depending on rooms. In case moving books exceed the capacity, find better solution in the room.
- Following rules for Student Room, do not bring unacceptable goods (TV, video game...) in the room.
- Do not bring the waste and garbage out of 'I building'.
- Move useful refrigerator and microwave to Refresh Lounge

# Schedule

- 7/24 new desks, chairs, shelves are delivered.

After that, moving work begins. You can bring your goods to your room by yourself.



# 1F

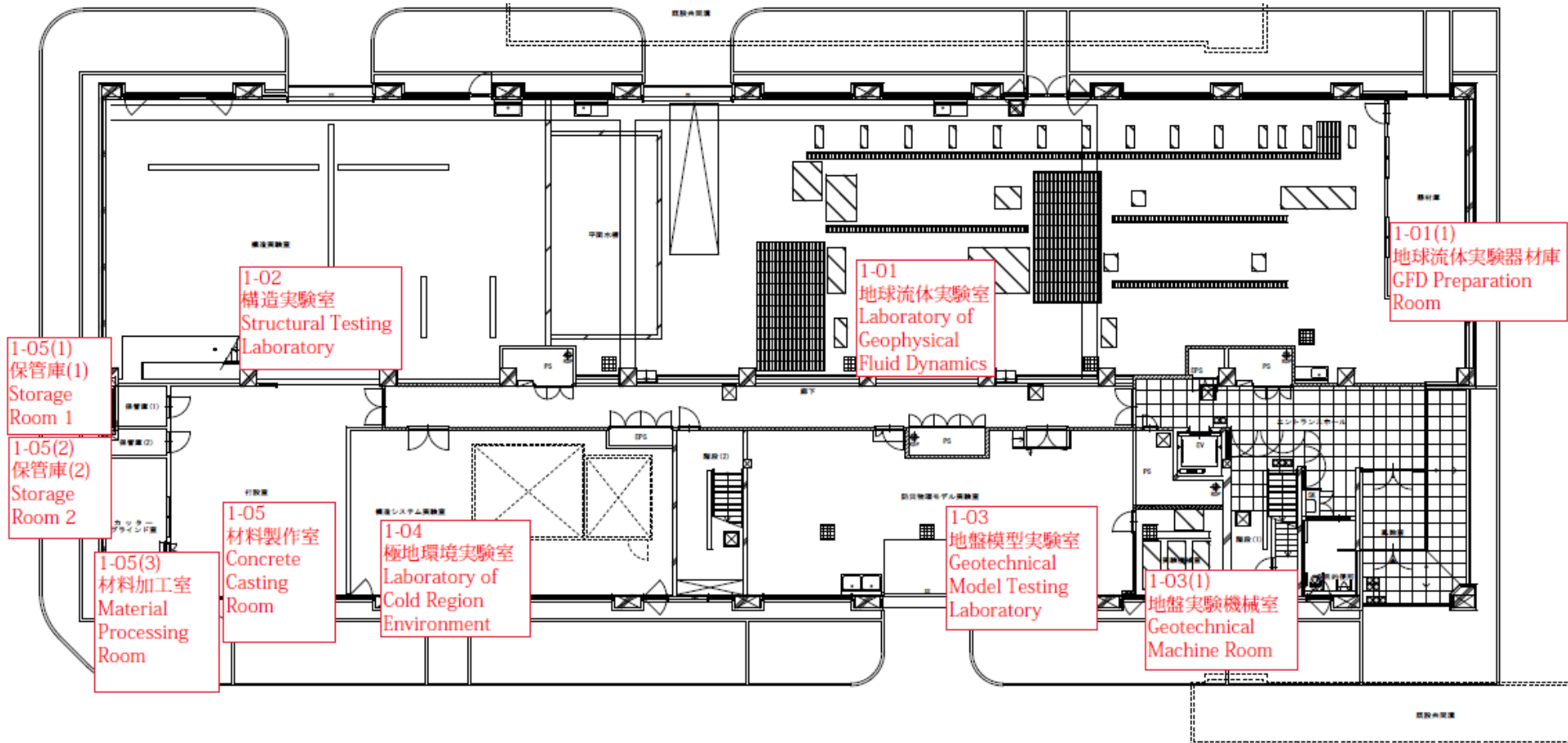

## 2F

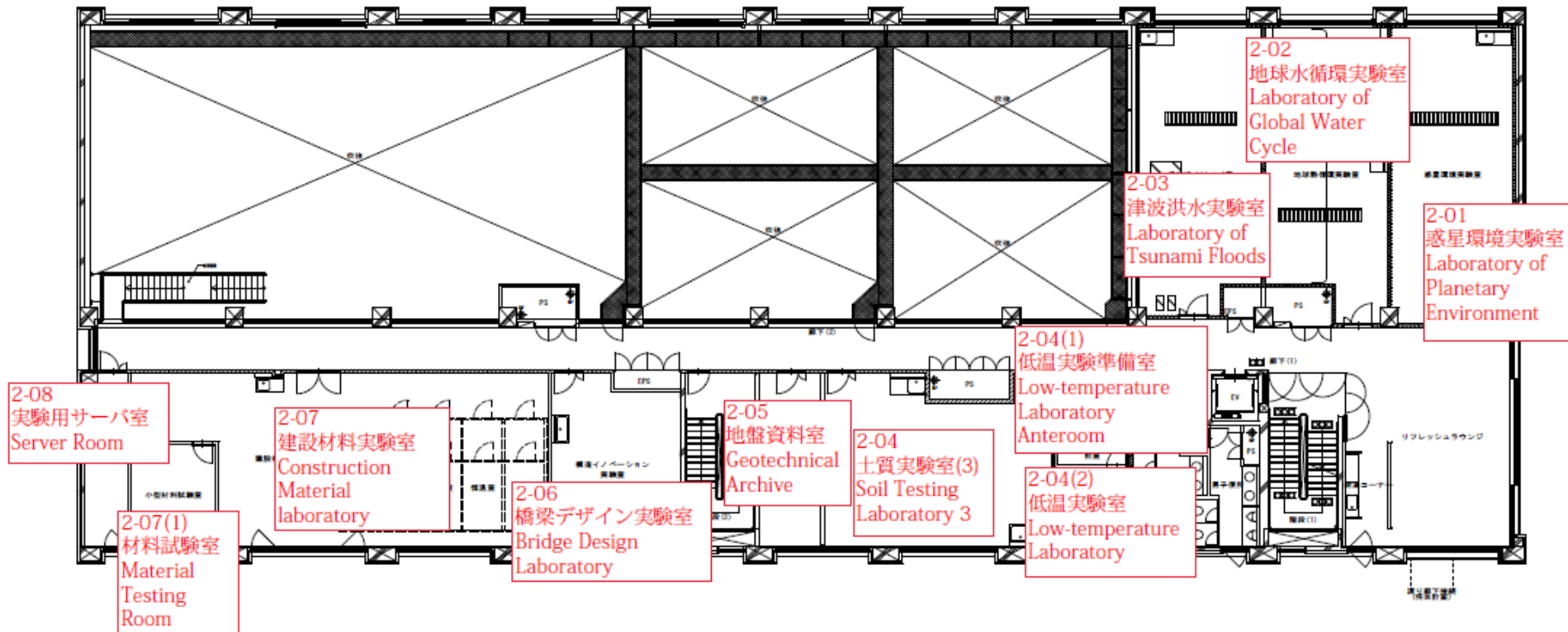

3F

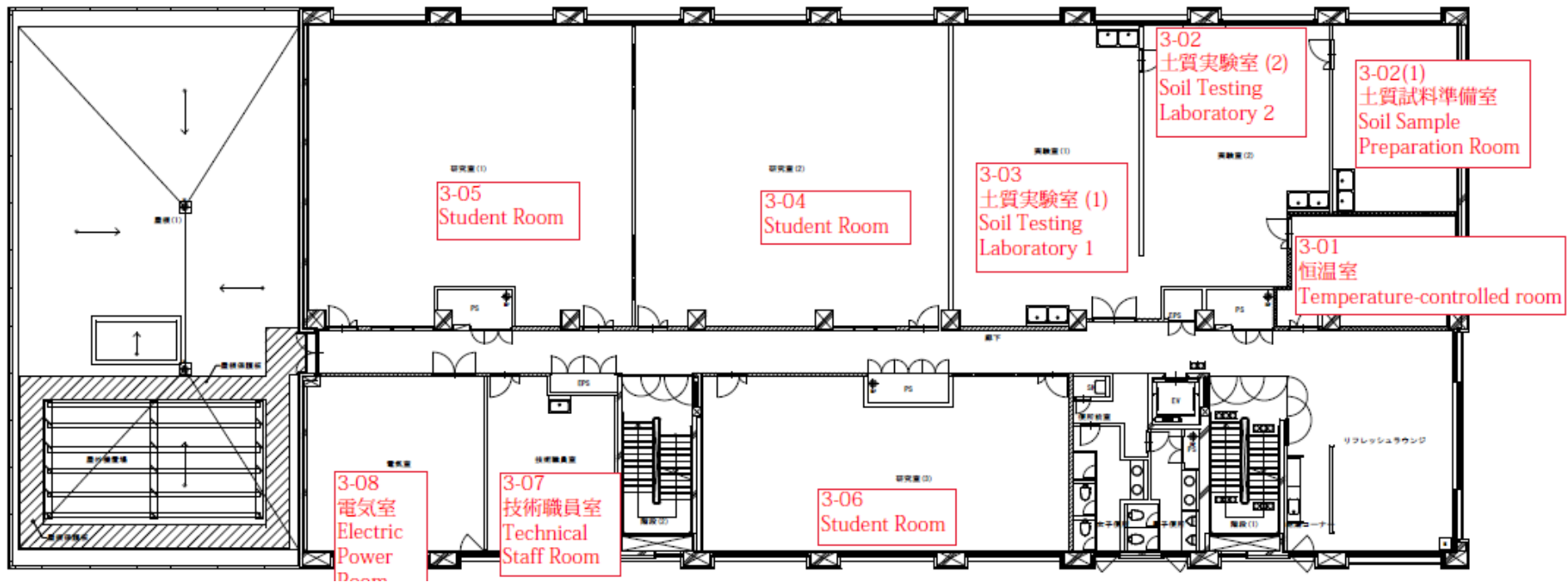

# 4F

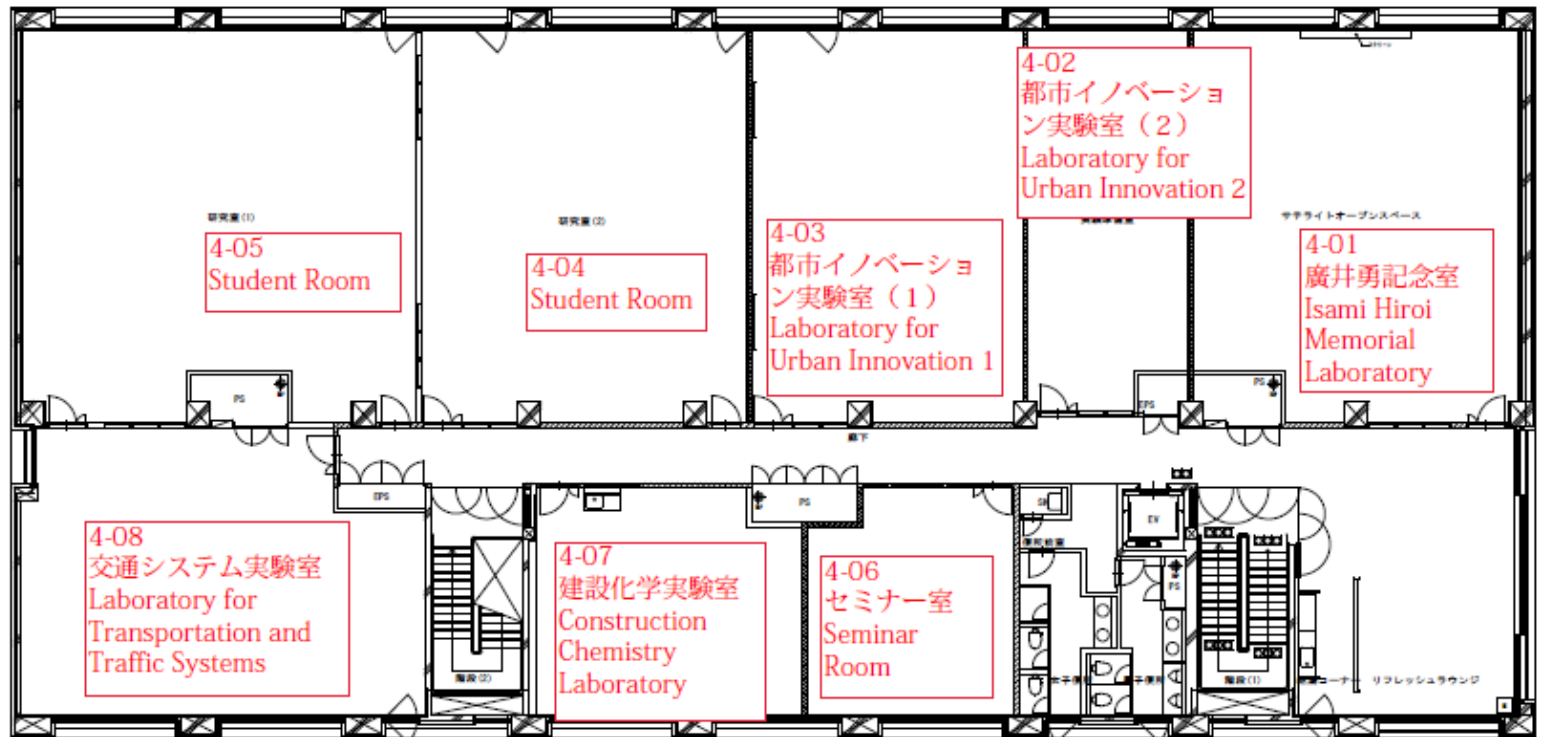

Many people spent long time to design  
better research environment for you.  
Past students donated to buy new goods  
for your research.  
Finally the new building has been  
established.

Please use cherish...